

IRENET CONTROL STATION D029 FINNER CAMP

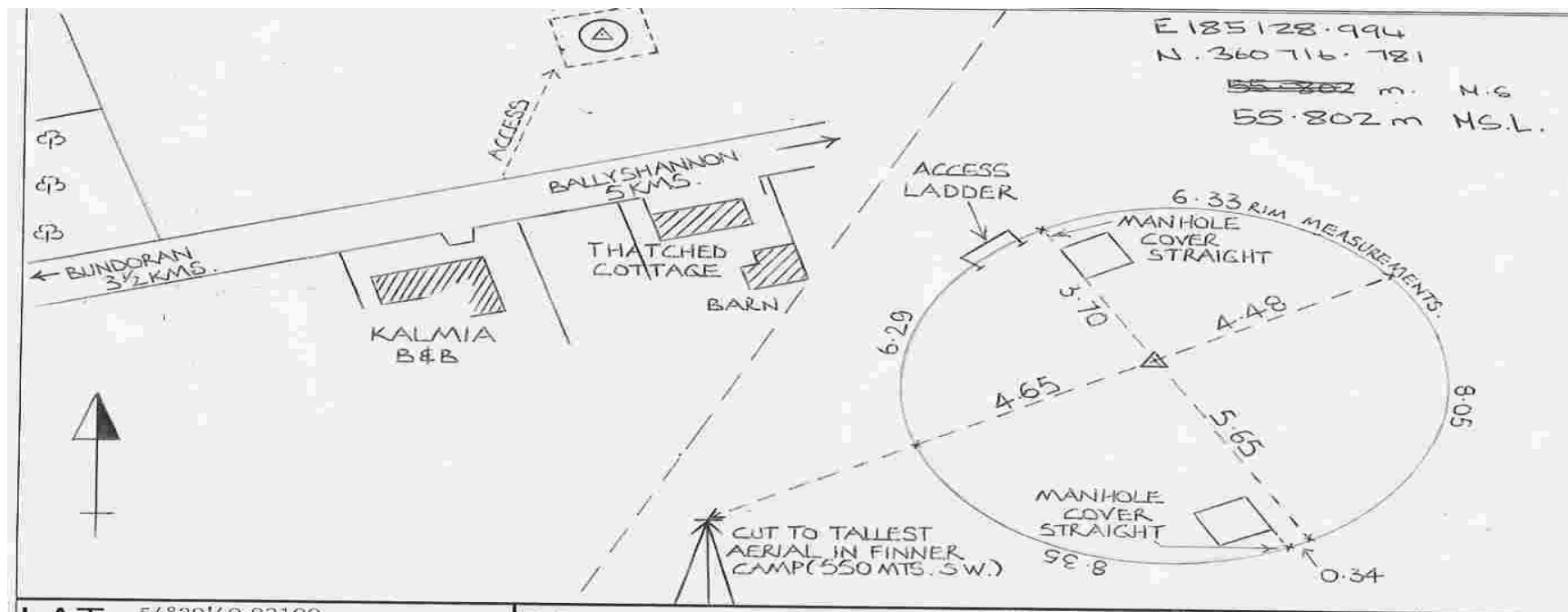

IRENET-95 COORDS. (ETRF89)

LAT 54° 29' 40.83199
LONG. 08° 13' 48.88574
ELLIP. HT. 113.4644

ITM COORDINATES

Easting: 585083.707
Northing: 860716.778
Ht. (MSL mts) 55.802

IRISH GRID COORDINATES

Easting: 185128.994
Northing: 360716.781
Ht. (MSL mts) 55.802

WRITTEN DESCRIPTION

This station consists of a brass rivet set on top of a low water tank that is approx. 550m N.E. of Finner camp on the Bundoran – Ballyshannon road. The tank is approx. 2.5m high and is accessed by a fixed ladder (see sketch).

GEODETIC SURVEYOR :

DATE: